

A type steel agricultural chains Landmaschinenketten A-Typ

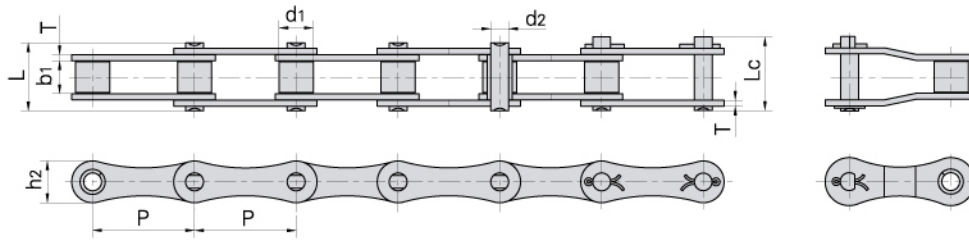

| Donghua Chain No. Donghua Ketten Nr. | Pitch | Roller diameter | Width between inner plates | Pin diameter | Pin length | | Plate dimension | | Ultimate tensile strength | Average tensile strength | Weight per meter |
|---|---------|--------------------|----------------------------|--------------------|--------------|--------------|---------------------|-------------|---------------------------|--------------------------|------------------|
| | Teilung | Rollen-durchmesser | Innere Breite | Bolzen-durchmesser | Bolzen-länge | | Laschen-abmessungen | | Min. Bruchkraft | Durchschn. Bruchkraft | Gewicht |
| | P mm | d1 max mm | b1 min mm | d2 max mm | L max mm | Lc max mm | h2 max mm | T max mm | Q min kN/LB | Q0 kN | q kg/m |
| A550 | 41.40 | 16.87 | 19.81 | 7.19 | 35.0 | 38.0 | 19.3 | 2.80 | 39.10/8886 | 51.2 | 1.79 |
| A555 | 41.40 | 16.87 | 12.70 | 7.19 | 29.1 | 32.0 | 19.3 | 3.10 | 39.10/8886 | 56.0 | 1.60 |
| A557 | 41.40 | 17.78 | 20.24 | 8.00 | 37.4 | 40.6 | 23.1 | 3.10 | 55.61/12639 | 74.3 | 2.45 |
| A620 | 42.01 | 17.91 | 24.51 | 7.19 | 41.8 | 45.2 | 20.2 | 3.25 | 39.10/8886 | 55.1 | 2.18 |

CA type steel agricultural chains Landmaschinenketten CA-Typ

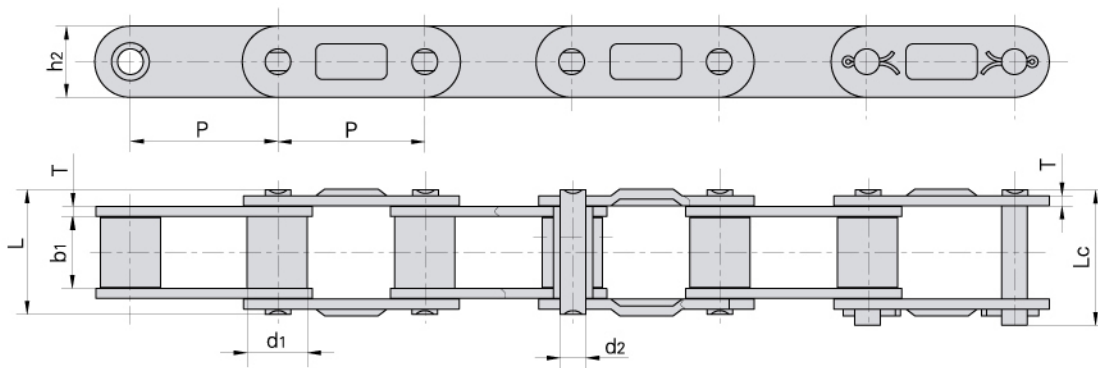

| Donghua Chain No. Donghua Ketten Nr. | Pitch | Roller diameter | Width between inner plates | Pin diameter | Pin length | | Plate dimension | | Ultimate tensile strength | Average tensile strength | Weight per meter |
|---|---------|--------------------|----------------------------|--------------------|--------------|--------------|---------------------|-------------|---------------------------|--------------------------|------------------|
| | Teilung | Rollen-durchmesser | Innere Breite | Bolzen-durchmesser | Bolzen-länge | | Laschen-abmessungen | | Min. Bruchkraft | Durchschn. Bruchkraft | Gewicht |
| | P mm | d1 max mm | b1 min mm | d2 max mm | L max mm | Lc max mm | h2 max mm | T max mm | Q min kN/LB | Q0 kN | q kg/m |
| CA627 | 30.00 | 15.88 | 19.05 | 8.28 | 36.1 | 39.4 | 20.5 | 3.00 | 50.0/11247 | 55.0 | 2.51 |
| CA550D | 41.40 | 16.87 | 19.81 | 7.19 | 35.0 | 38.0 | 19.3 | 2.80 | 39.10/8886 | 51.2 | 1.94 |
| CA555D | 41.40 | 16.87 | 12.70 | 7.19 | 29.1 | 32.0 | 19.3 | 3.10 | 39.10/8886 | 56.0 | 1.72 |
| CA557D | 41.40 | 17.78 | 20.24 | 8.00 | 37.4 | 40.6 | 23.1 | 3.10 | 55.61/12639 | 74.3 | 2.60 |
| CA620D | 42.01 | 17.91 | 24.51 | 7.19 | 41.8 | 45.2 | 20.2 | 3.25 | 39.10/8886 | 55.1 | 2.35 |

CA type steel agricultural chains

Landmaschinenketten CA-Typ

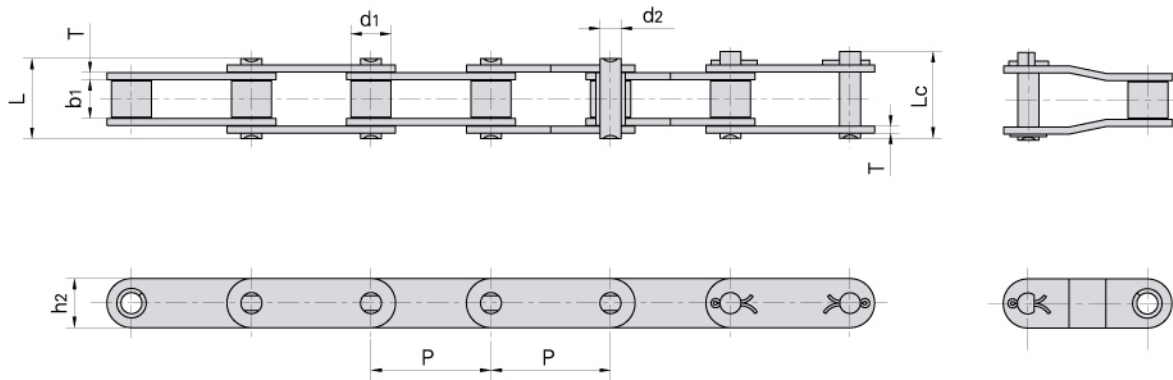

| Donghua Chain No. Donghua Ketten Nr. | Pitch | Roller diameter | Width between inner plates | Pin diameter | Pin length | | Plate dimension | | Ultimate tensile strength | Average tensile strength | Weight per meter |
|---|---------|--------------------|----------------------------|--------------------|----------------|-----------------|-----------------|----------------|---------------------------|--------------------------|------------------|
| | Teilung | Rollen-durchmesser | Innere Breite | Bolzen-durchmesser | L | Lc | h2 | T | Min. Bruchkraft | Durchschn. Bruchkraft | Gewicht |
| | P mm | d1 max mm | b1 min mm | d2 max mm | L max mm | Lc max mm | h2 max mm | T max mm | Q min kN/LB | Q0 kN | q kg/m |
| CA550 | 41.400 | 16.87 | 19.81 | 7.19 | 35.0 | 38.0 | 19.30 | 2.80 | 39.10/8886 | 51.2 | 1.94 |
| CA550V | 41.400 | 16.80 | 19.05 | 8.28 | 36.1 | 39.1 | 22.00 | 3.00 | 55.00/12499 | 68.7 | 2.24 |
| CA555 | 41.400 | 16.87 | 12.70 | 7.19 | 29.1 | 32.0 | 19.30 | 3.10 | 39.10/8886 | 56.0 | 1.72 |
| CA557 | 41.400 | 17.78 | 20.24 | 8.00 | 37.4 | 40.6 | 23.10 | 3.10 | 55.61/12639 | 74.3 | 2.60 |
| CA620 | 42.010 | 17.91 | 24.51 | 7.19 | 41.8 | 45.2 | 20.20 | 3.25 | 39.10/8886 | 55.1 | 2.35 |
| CA2060H | 38.100 | 11.91 | 12.70 | 5.94 | 29.2 | 31.6 | 18.00 | 3.25 | 31.10/6996 | 40.5 | 1.45 |
| CA2063H | 38.100 | 11.89 | 12.70 | 5.94 | 29.4 | 34.2 | 19.30 | 3.25 | 31.28/7109 | 40.5 | 1.65 |
| CA550F4 | 41.400 | 14.35 | 20.24 | 7.14 | 35.0 | 38.5 | 19.05 | 2.80 | 50.00/11363 | 52.0 | 1.76 |
| CA550F5 | 41.400 | 16.66 | 20.24 | 7.14 | 35.0 | 38.5 | 19.05 | 2.80 | 45.00/10227 | 52.0 | 1.97 |
| CAE44151 | 28.575 | 15.88 | 16.20 | 7.92 | 33.5 | 36.9 | 22.20 | 3.25 | 58.80/13363 | 64.5 | 2.73 |
| 38.4R | 38.400 | 15.88 | 19.05 | 6.92 | 33.8 | 36.4 | 17.30 | 2.50 | 33.00/7480 | 41.2 | 1.70 |
| 38.4V | 38.400 | 15.88 | 18.00 | 6.92 | 35.0 | 38.0 | 17.30 | 3.00 | 40.00/9091 | 50.0 | 1.83 |
| 38.4VB | 38.400 | 15.88 | 19.05 | 8.28 | 36.1 | 39.4 | 20.50 | 3.00 | 50.00/11363 | 62.5 | 2.17 |
| 55VD | 41.400 | 17.90 | 23.00 | 8.22 | 39.3 | 42.4 | 20.00 | 2.80 | 42.00/9546 | 45.0 | 2.34 |
| S62F3 | 41.910 | 19.05 | 25.40 | 8.00 | 42.0 | 44.6 | 26.00 | 3.00 | 47.00/10796 | 58.7 | 3.12 |
| CA960 | 41.400 | 17.78 | 22.61 | 8.90 | 40.1 | 43.0 | 23.10 | 3.00 | 66.00/15160 | 72.6 | 6.94 |
| CA550VF2 | 41.400 | 16.80 | 19.05 | 8.28 | 36.1 | 38.8 | 20.00 | 3.00 | 55.00/12499 | 68.7 | 2.13 |
| CA550H | 41.400 | 16.74 | 20.00 | 7.14 | 36.0 | 39.1 | 19.10 | 3.00 | 57.82/13000 | 60.8 | 2.00 |